



section

# 5

## HERMETIC SERIES (EPC)



### SECTION 5

General information	38
Contact arrangement	38
Hermetic series	39
How to order	40



Environmentally Sealed rectangular D-Subminiature connectors are designed primarily for applications where space and weight are of a major importance.

These connectors are mainly for use in aerospace, military, telecommunications and wherever protection and reliability are needed.

Compatibility with standards :

- UTE C 93-425, type HE 508
- MIL-C-24308-DEF 5935 Pattern 110
- IEC Empfehlung 48B

### CONTACT ARRANGEMENT HERMETIC SERIES

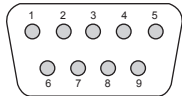

**E-9**

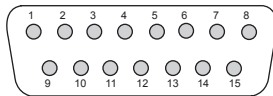

**A-15**

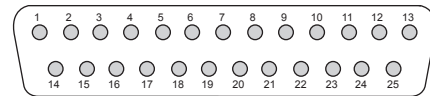

**B-25**

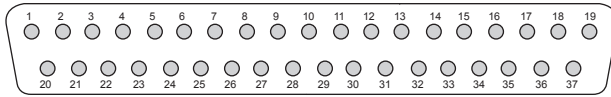

**C-37**

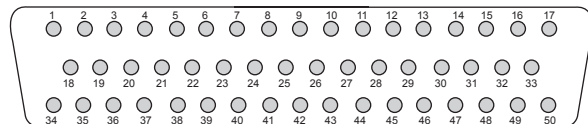

**D-50**

D-SUBMINIATURE CONNECTORS  
HERMETIC SERIES (EPC)

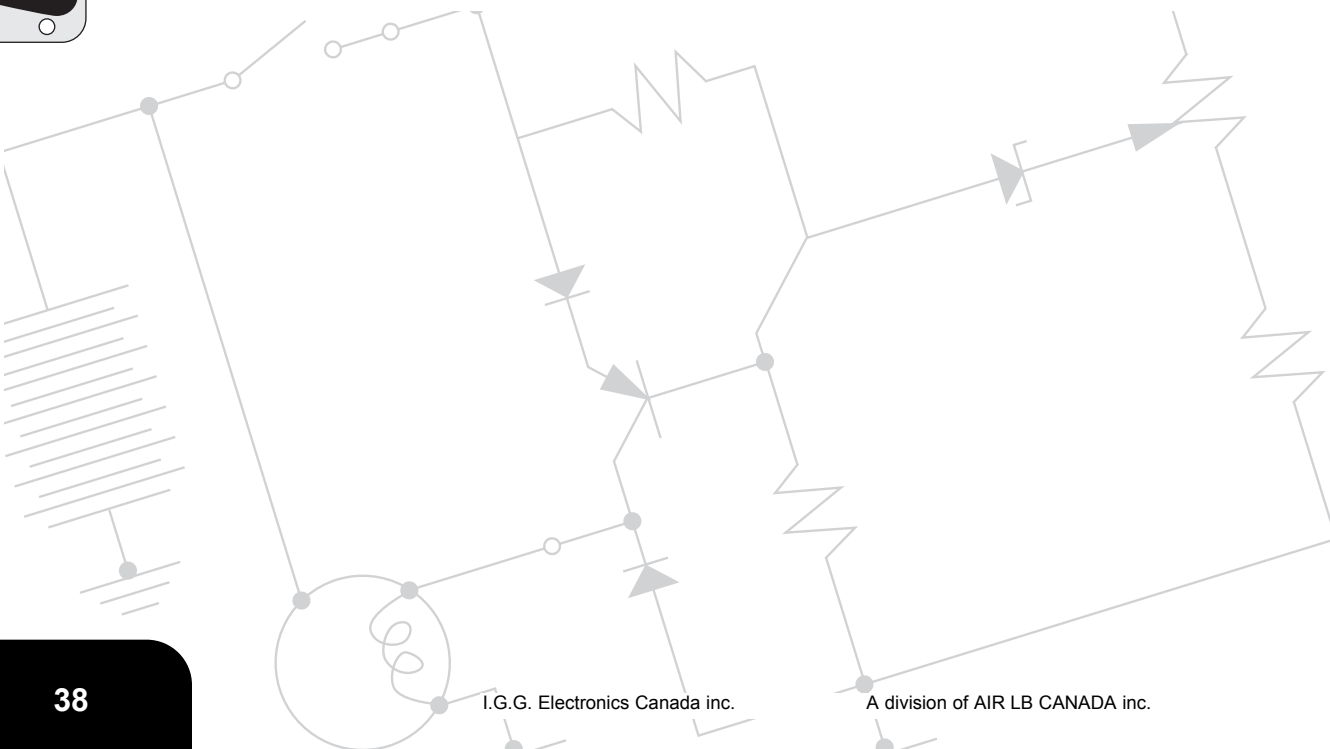

### Hermetic Series (EPC)

Environmentally sealed D-subminiature connectors are designed primarily for applications where space and width are of major importance.

#### Technical Data

Shell : Zinc dichromated steel  
 Insulator : DAP resin / Silicone elastomer  
 Contacts : Copper alloy, gold over nickel plating

Nb of matings : 500 cycles  
 Operating temperature : -55°C +155°C

Max voltage in V RMS 50 Hz : 1000  
 Rated voltage in V RMS 50 Hz : 300  
 Max current rating per contact : 7 A  
 Insulating resistance :  $\geq 5 \text{ G}\Omega$   
 Contact resistance :  $\leq 10 \text{ m}\Omega$

#### SEALED CRIMPED HOUSING

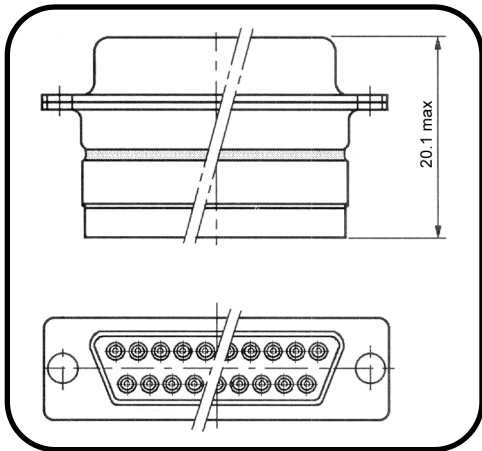

CONTACTS		PART NUMBER
9	male	EPC09PSP021
	female	EPC09SSP021
15	male	EPC09PSP021
	female	EPC15SSP021
25	male	EPC25PSP021
	female	EPC25SSP021
37	male	EPC37PSP021
	female	EPC37SSP021
50	male	EPC50PSP050
	female	EPC50SSP050

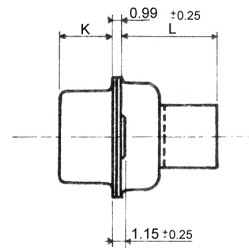
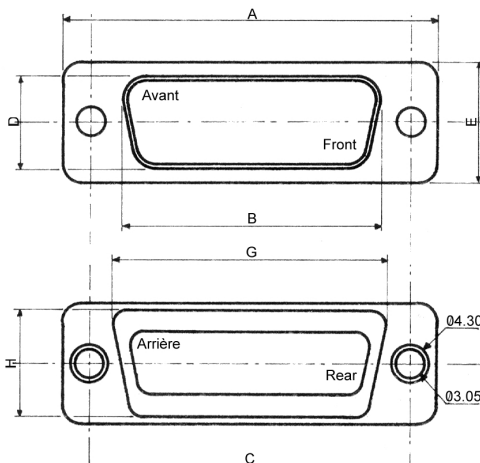

Montage Flottant

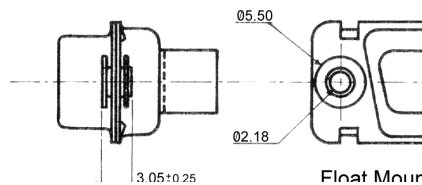

D-SUBMINIATURE CONNECTORS  
HERMETIC SERIES (EPC)

### How to order

For contact selection, please refer to page 9 of section 1.

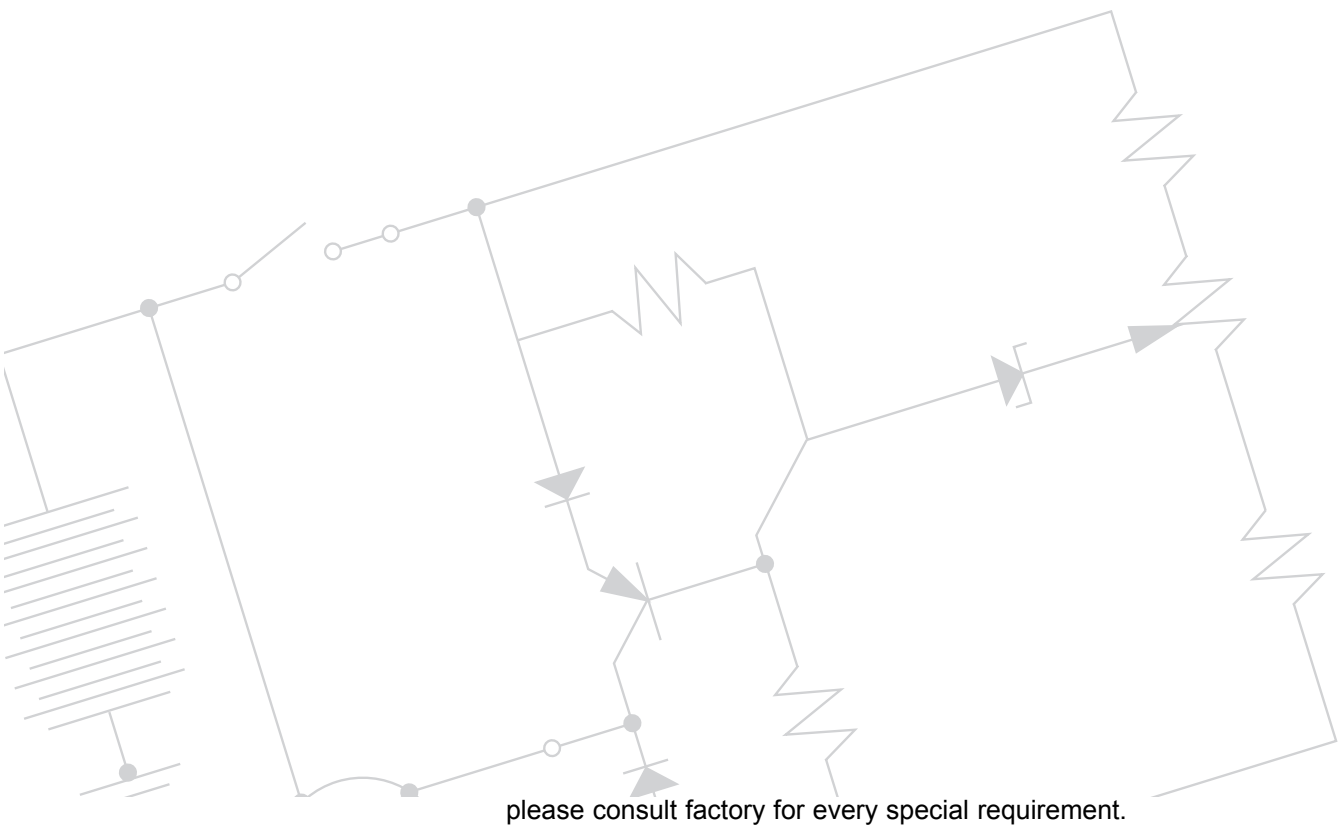
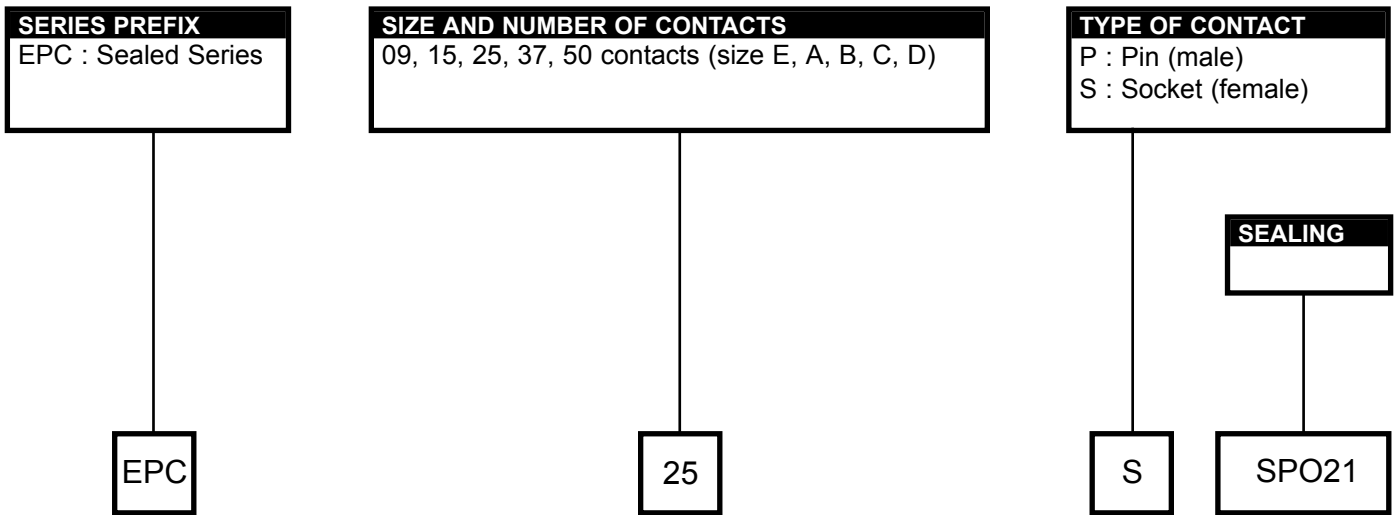

please consult factory for every special requirement.